

## S4 WAFER CHECK VALVE PVC, PP AND PVDF

### A: INSTALLATION

All S4 series wafer type check valves are designed to fit between flat face flanges, 150 lbs rated.

Observe flow direction before installing valve.

Handle valve carefully and do not drop valve—large PVC valves are very sensitive to drop impact.

Use eyebolt supplied to lift valve and for inserting between flanges.

Eyebolt must be in upward position when valve is installed in horizontal pipes.

Refer to technical data sheet for recommended maximum flow rates and start up flow rates.

Low torque flange gaskets are required for PP wafer check valves. PVC wafer check valves contain a body O-Ring seal and do not require low torque flange gaskets.

Centre by means of body rim (external) diameter.

Assemble between DIN/ANSI flanges. Use soft gaskets and tighten.

Flange bolts should be well lubricated. With plastic flanges it is important to use washers.

Tighten bolts with a torque wrench evenly and in symmetrical pattern as shown below.

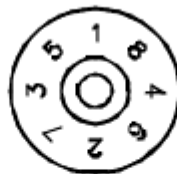

The following should be observed when assembling on to the discharge side of the pump:

- (a) Never assemble directly on to pump flange.
- (b) Never assemble on to a bend or elbow.
- (c) Allow an additional distance of 5 - 10 times the nominal width before installing the wafer check valve.

See Praher’s technical specification sheet for flow booster or spacer rings, which are required for schedule 80 piping systems. These spacer rings prevent valve disc slamming against the mating flanges.

The recommended torques are tabled below:

Valve Size	Bolt Torque (ft-lb)	
	PVC	PP
2"	20-30	12.3
2-1/2"	20-30	14.5
3"	20-30	14.5
4"	20-30	14.5
5"	-	18.1
6"	33-50	18.1
8"	33-50	21.7
10"	53-75	25.4
12"	80-100	29.0

**B: MAINTENANCE**

1. Remove spring (6) by putting tension on lower portion and pushing upward.
2. Loosen screws (5) and remove disc (4).
3. Inspect disc and O-rings (3) for wear and replace if necessary.
4. Inspect body O-rings (2) for wear and replace if necessary.
5. To re-assemble valve repeat steps 4 through 1 in reverse. Do not over tighten screws (5).

See next page for part identification:

## PVC, PP & PVDF WAFER CHECK VALVES

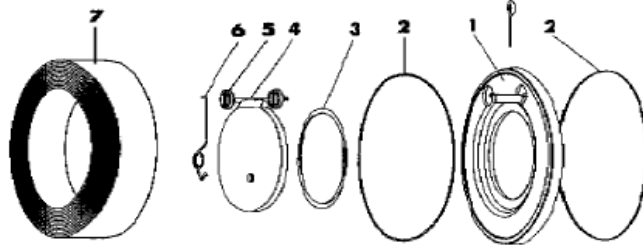

PART	DESCRIPTION	PCS.	MATERIAL
1	BODY	1	PVC, PP, PVDF
2	O-RING	2	EPDM, VITON, VT
3	DISC O-RING	1	EPDM, VITON, VT
4	DISC	1	PVC, PP, PVDF
5	SCREW	1	SS 316
6	SPRING	1	SS 316
7	SPACER	1	PVC, PP

